

HIGHWAY ASSET MANAGEMENT

PROGRAMME OF WORKS 2024-25

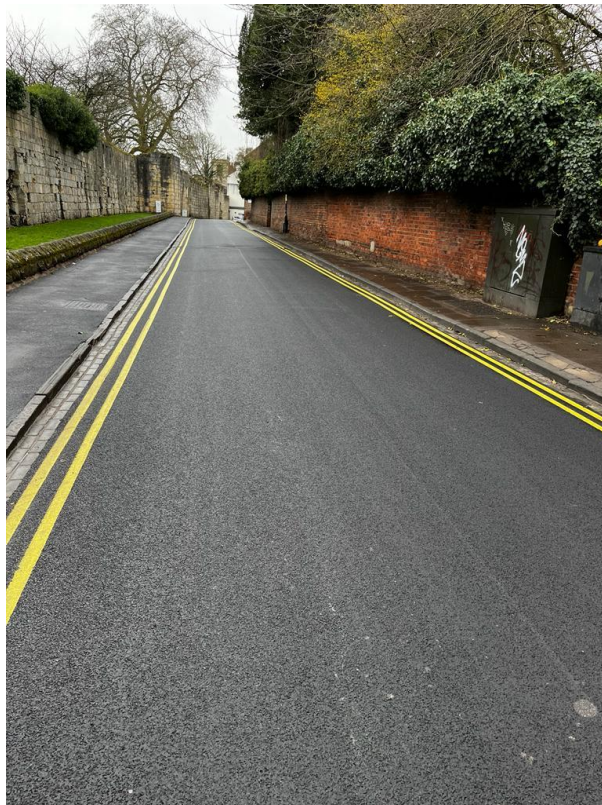

RESURFACING 2024-2025

HIGHWAY ASSET MANAGEMENT
Hazel Court
James Street
YORK
YO10 3DS

JAN 2024

HIGHWAY RESURFACING 24-25			
Street	Location	Ward	Type of works
1 York Road	Oak Rise Roundabout to Fairfax Close	Acomb, Holgate, Westfield	Plane and resurface
2 Clifton Park Avenue	Shipton rd – The Dormouse junction	Rawcliffe and Clifton Without	Plane and resurface
3 Halifax Way	Harrier Ct – Bed end Elvington In jn	Wheldrake	Plane and resurface
4 Bishopthorpe Road	Campleshon rd- Balmoral Terr	Micklegate	Plane and resurface
5 Malton Road	Hopgrove Fm cotts, Little Hopgrove RB, A1237 link to Hopgrove Roundabout	Huntington and New Earswick, Strensall	Plane and resurface
6 A1079 Grimston Approach	York Rd Junction to Grimston bar Roundabout	Osballdwick & Derwent	Plane and resurface
7 Elvington Lane -The Maze	Clock Fm – Common lane	Osballdwick & Derwent	Plane and resurface
HIGHWAY CONCRETE ROAD REPAIR 24-25			
8 Almsford Road Acomb	Cranbrook Rd- Carr Ln	Acomb	Concrete

LTP CARRIAGEWAY PROGRAMME

ITEM	<input type="text" value="1"/>		
LOCATION	<input type="text" value="York Road"/>		
ROAD NO	<input type="text"/>		
WARD/PARISH	<input type="text" value="Acomb, Holgate, Westfield"/>		
SCHEME DRAWING NO	<input type="text"/>		
DESCRIPTION OF WORK	<input type="text" value="Resurfacing from Oak Rise Roundabout to Fairfax Close"/>		
<i>SPECIFICATION RECOMMENDATION</i>	<input type="text" value="carriageway resurfacing"/>		
CW WIDTH	<input type="text" value="10"/>	FW WIDTH	<input type="text"/>
CW LENGTH	<input type="text" value="471"/>	FW LENGTH	<input type="text"/>
CW AREA	<input type="text" value="Approx. 4710"/>		<input type="text"/>
FEE	<input type="text"/>		
TOTAL ESTIMATE	<input type="text" value="£ 405073"/>		

NOTES

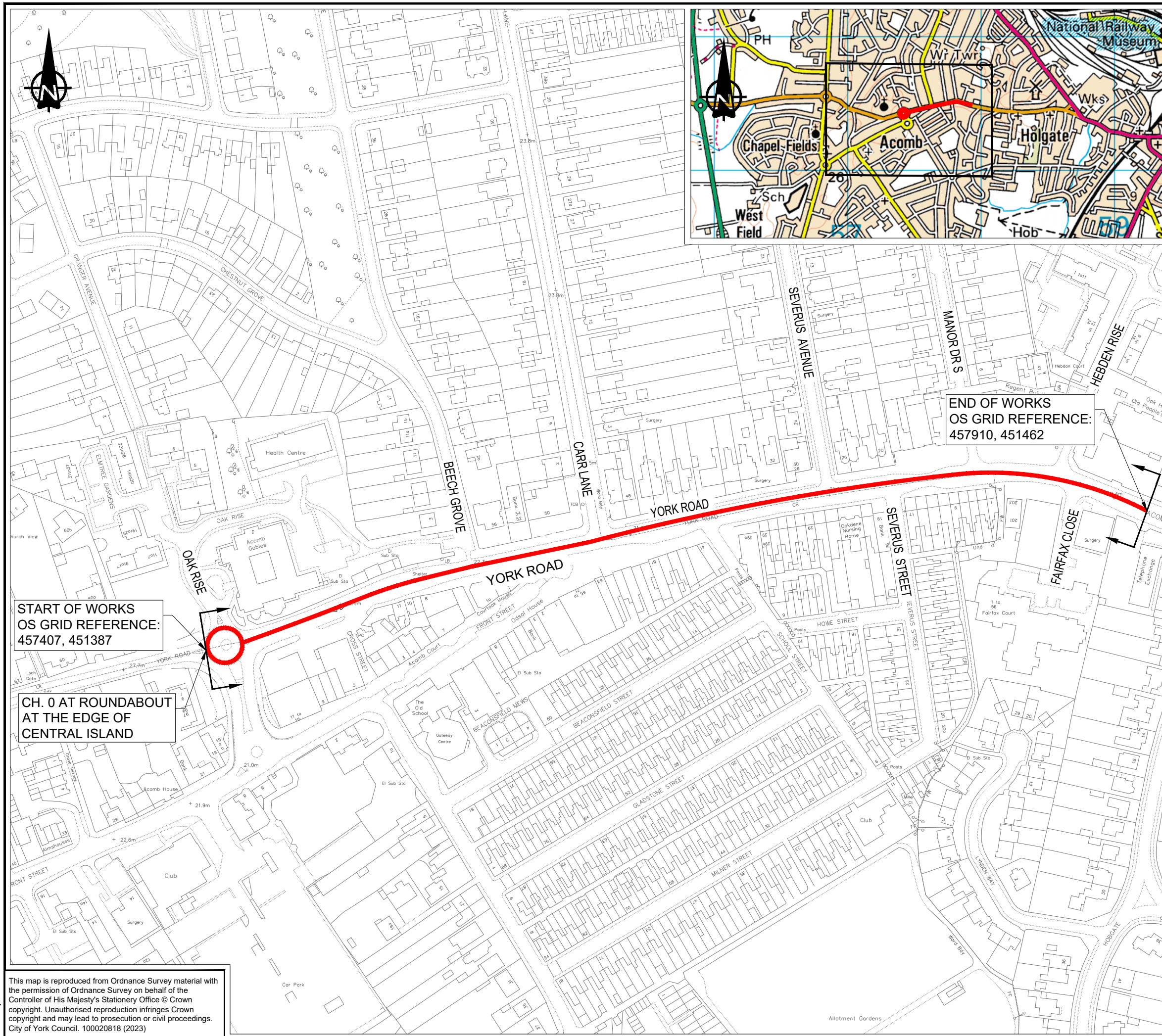

DO NOT SCALE

NOTES:

THIS DRAWING IS BASED ON AN ORDNANCE SURVEY PLAN, THEREFORE THERE MAY BE INACCURACIES WITH THE LAYOUT.

KEY:

— SITE LOCATION AND EXTENTS.

P01	20-10-2023	KC	FIRST ISSUE	SD	SP
REV	DATE	BY	DESCRIPTION	CHK	APP

DRAWING STATUS: **D2 - FOR TENDER**



Dale House, Mount View, Standard Way Business Park, Northallerton
DL6 2YD, UK
wsp.com



PROJECT: **CITY OF YORK CAPITAL MAINTENANCE 24-25
B1224 YORK ROAD**

TITLE: **LOCATION PLAN**

SCALE @ A3:	CHECKED:	APPROVED:	
NTS	SD	SP	
PROJECT No:	DESIGNED:	DRAWN:	DATE:
70112373	SB	KC	20/10/2023
DRAWING No:	70112373-006-WSP-100		REV:
			P01

© WSP UK Ltd

This map is reproduced from Ordnance Survey material with the permission of Ordnance Survey on behalf of the Controller of His Majesty's Stationery Office © Crown copyright. Unauthorised reproduction infringes Crown copyright and may lead to prosecution or civil proceedings. City of York Council. 100020818 (2023)

LTP CARRIAGEWAY PROGRAMME

ITEM

2

LOCATION

Clifton Park Avenue

ROAD NO

WARD/PARISH

Rawcliffe and Clifton Without

SCHEME DRAWING NO

DESCRIPTION
OF WORK

Patch and Resurfacing between Mulberry ct jn & Shipton rd

*SPECIFICATION
RECOMMENDATION*

carriageway resurfacing

CW WIDTH

Av 6.5m some only
3.5

FW WIDTH

CW LENGTH

95

FW LENGTH

CW AREA

Approx. 500

FEE

TOTAL ESTIMATE

£30210

NOTES

--

File name \\UK\WSPGROUP\IP\CENTRAL DATA\PROJECTS\70112373 - CYC - CAPITAL MAINTENANCE DESIGN\24-25\03\WPC\CLIFTON PARK AVENUE\3 DOCUMENTS & DRAWINGS\DRAWINGS\70112373-010-WSP-100.DWG, printed on 24 October 2023 09:46:15, by Walker, Abbey

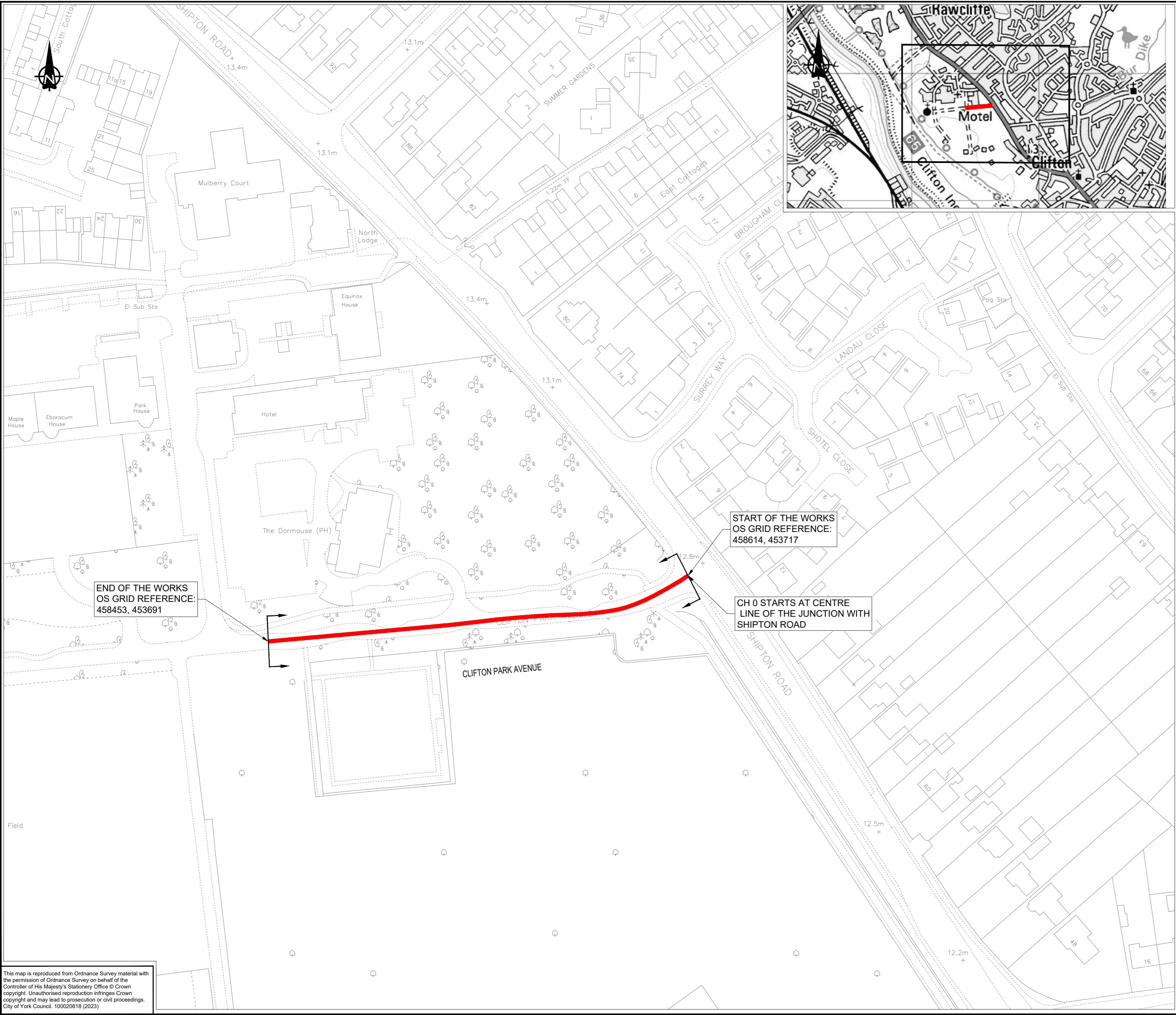

DO NOT SCALE

NOTES:
 1. THIS DRAWING IS BASED ON AN ORDNANCE SURVEY PLAN, THEREFORE THERE MAY BE INACCURACIES WITH THE LAYOUT.

KEY:
 SITE EXTENTS

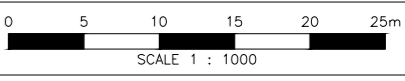

P01	19/10/2023	AY	FIRST ISSUE		
REV	DATE	BY	DESCRIPTION	CHK	APP

DRAWING STATUS: **D2 - FOR TENDER**



Dale House, Mount View, Standard Way Business Park, Northalerton
 DL6 2YD, UK
 wsp.com



PROJECT:
**CITY OF YORK CAPITAL MAINTENANCE 24-25
 CLIFTON PARK AVENUE**

TITLE:
LOCATION PLAN

SCALE @ A2: 1:1000	CHECKED: DV	APPROVED: SP
PROJECT No: 70112373	DESIGNED: AY	DRAWN: AY
	DATE: 19/10/2023	
DRAWING No: 70112373-010-WSP-100	REV: P01	

© WSP UK Ltd

This map is reproduced from Ordnance Survey material with the permission of Ordnance Survey on behalf of the Controller of His Majesty's Stationery Office © Crown copyright. Unauthorised reproduction infringes Crown copyright and may lead to prosecution or civil proceedings. City of York Council. 100020818 (2023)

LTP CARRIAGEWAY PROGRAMME

ITEM

3

LOCATION

Halifax Way

ROAD NO

WARD/PARISH

Wheldrake

SCHEME DRAWING NO

DESCRIPTION
OF WORK

Resurfacing from Harrier Ct – Bed end Elvington In jn

*SPECIFICATION
RECOMMENDATION*

carriageway resurfacing

CW WIDTH

7

FW WIDTH

CW LENGTH

258

FW LENGTH

CW AREA

Approx. 1806

FEE

TOTAL ESTIMATE

£ 310387

NOTES

--

KEY:



Cold mill 110mm
 Apply Tack Coat
 Lay 60mm thick 20mm HD Binder
 course followed by 50 mm HRA
 +PCC chips

NOTES:

1. All dimensions in metres unless otherwise stated.
 2. Do not scale from this drawing.
 3. Any issues should be raised with the scheme engineer immediately.
- Traffic Management
 Closure of road

1795 m²

HSE
 Remote Rural area
 Very heavy vehicles use the road
 Operational Airfield

BASED UPON THE ORDINANCE SURVEY MAPPING WITH THE PERMISSION OF THE CONTROLLER OF HER MAJESTY'S STATIONERY OFFICE. © CROWN COPYRIGHT. UNAUTHORISED REPRODUCTION INFRINGES CROWN COPYRIGHT AND MAY LEAD TO PROSECUTION OR CIVIL PROCEEDINGS. City of York Council OS Licence No. 1000 20818

PLANNING ISSUE

Revision	By	Checked	Approved	Date	Description
A	XX	XX	XX	0X/17	Planning issue



Highways – Transport Projects and Delivery Team
 Eco Depot, Hazel Court, James Street, York, YO10 3DS
 www.york.gov.uk

Project
 2020/21 Large Patching Schemes

Drawing
 Proposed Programmes
 Wheldrake
 Halifax Way

Drawn by CSS Date: XXXXXX
 Checked by A N OTHER Date: XXXXXX
 Authorised by A N OTHER Date: XXXXXX

Drawing No.	Revision
	A

Drawing Scale: 1:12500 A1

CAD Filename: Computer Filename Plot Scale: 100



LTP CARRIAGEWAY PROGRAMME

ITEM

4

LOCATION

Bishopthorpe Road

ROAD NO

WARD/PARISH

Micklegate

SCHEME DRAWING NO

DESCRIPTION
OF WORK

Resurfacing between Camplshon rd and Balmoral terr

*SPECIFICATION
RECOMMENDATION*

carriageway resurfacing

CW WIDTH

Av 8.5m

FW WIDTH

CW LENGTH

170

FW LENGTH

CW AREA

1445

FEE

TOTAL ESTIMATE

£155325

NOTES

--

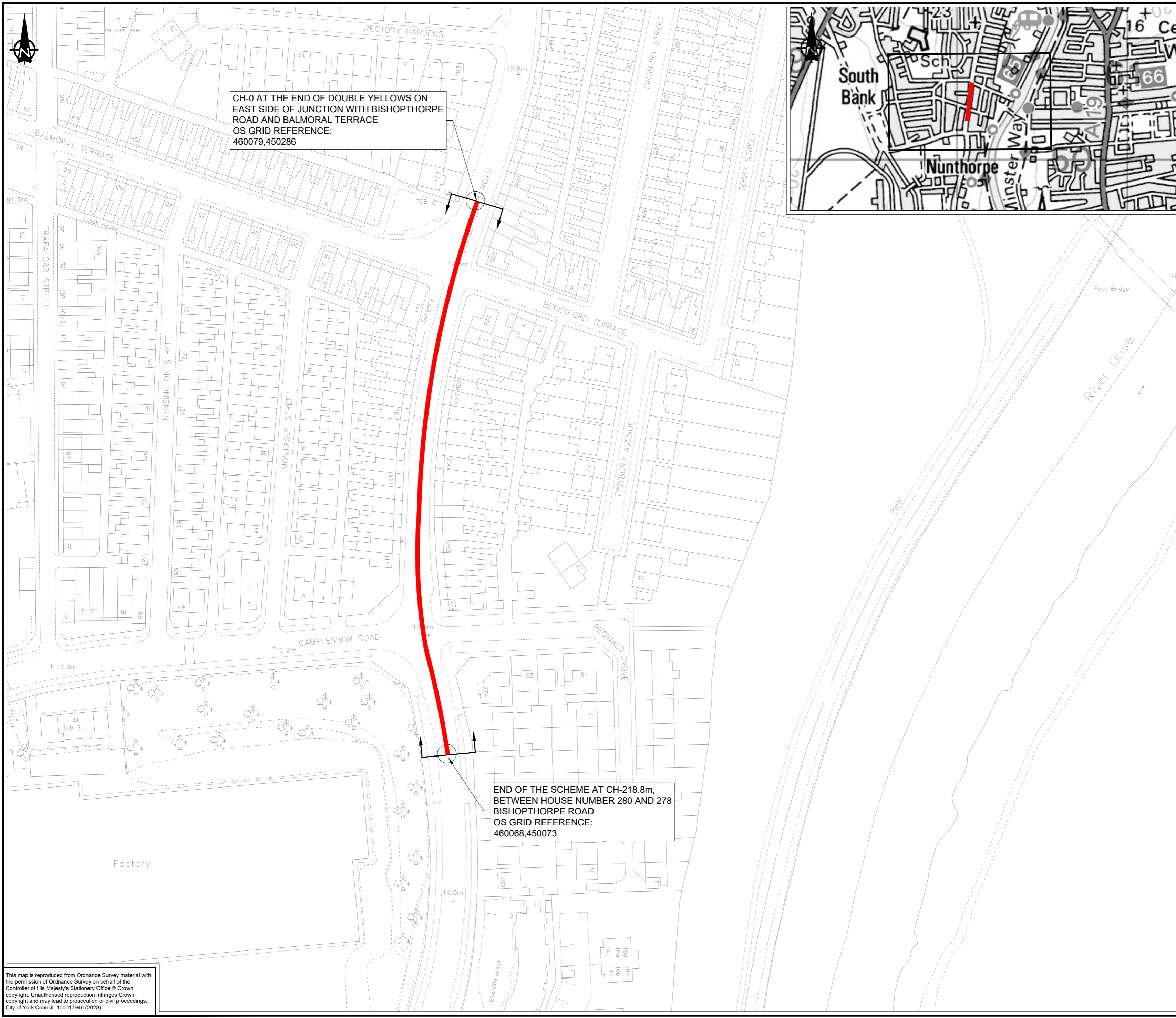

CH-0 AT THE END OF DOUBLE YELLOWS ON EAST SIDE OF JUNCTION WITH BISHOPTHORPE ROAD AND BALMORAL TERRACE
OS GRID REFERENCE:
460079,450286

END OF THE SCHEME AT CH-218.8m,
BETWEEN HOUSE NUMBER 280 AND 278
BISHOPTHORPE ROAD
OS GRID REFERENCE:
460068,450073



DO NOT SCALE

NOTES:
1. THIS DRAWING IS BASED ON AN ORDNANCE SURVEY PLAN, THEREFORE THERE MAY BE INACCURACIES WITH THE LAYOUT.

KEY:
— EXTENT OF WORKS

P01	19/10/2023	AK	FIRST ISSUE	DV	AC
REV	DATE	BY	DESCRIPTION	CHK	APP

DRAWING STATUS: **D2 - FOR TENDER**



Dale House, Mount View, Standard Way Business Park, Northallerton, DL6 2YD, UK
wsp.com

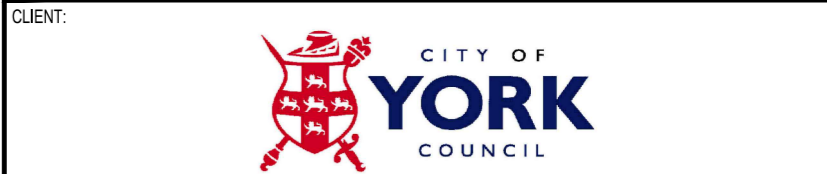

PROJECT:
**CITY OF YORK CAPITAL MAINTENANCE -24/25
BISHOPTHORPE ROAD (SECTION 02)**

TITLE:
**LOCATION PLAN
SHEET 2 OF 2**

SCALE @ A2: NTS	CHECKED: DV	APPROVED: AC
PROJECT No: 70112373	DESIGNED: AK	DRAWN: AK
		DATE: 19/10/2023

DRAWING No: 70112373-012-WSP-101	REV: P01
--	--------------------

© WSP UK Ltd

File name C:\USERS\SINK\4851\DOCUMENTS\1\WORK\41.BISHOPTHORPE ROAD\3 DOCUMENTS & DRAWINGS\DRAWINGS\70112373-012-WSP-101 & 101.LOCATION PLAN_SECTION 1 & SECTION 2.DWG, printed on 20 October 2023 00:16:12, by Kumar, Ajay

This map is reproduced from Ordnance Survey material with the permission of Ordnance Survey on behalf of the Controller of His Majesty's Stationery Office © Crown copyright. Unauthorised reproduction infringes Crown copyright and may lead to prosecution or civil proceedings. City of York Council, 100017946 (2023)

LTP CARRIAGEWAY PROGRAMME

ITEM	<input type="text" value="5"/>		
LOCATION	<input type="text" value="Malton Road"/>		
ROAD NO	<input type="text"/>		
WARD/PARISH	<input type="text" value="Huntington and New Earswick, Strensall"/>		
SCHEME DRAWING NO	<input type="text"/>		
DESCRIPTION OF WORK	<input type="text" value="Resurfacing from Hopgrove Fm cotts,to Little Hopgrove RB, A1237 link to Hopgrove Roundabout"/>		
<i>SPECIFICATION RECOMMENDATION</i>	<input type="text" value="carriageway resurfacing"/>		
CW WIDTH	<input type="text" value="11.5"/>	FW WIDTH	<input type="text"/>
CW LENGTH	<input type="text" value="650"/>	FW LENGTH	<input type="text"/>
CW AREA	<input type="text" value="Approx. 7475"/>		<input type="text"/>
FEE	<input type="text"/>		
TOTAL ESTIMATE	<input type="text" value="£ 306484"/>		

NOTES

File name: \\UK.WSPGROUP.COM\CENTRAL\DATA\PROJECTS\70112373-CYC-CAPITAL MAINTENANCE DESIGN\24-25\03 WIP\MALTON ROAD TO NEW LANE\DRAWINGS & DOCUMENTS\REDESIGN\DRAWINGS\70112373-008-WSP-100-LOCATION PLAN REV.P02.DWG, printed on 24 November 2023 12:47:44, by Walker, Abbey

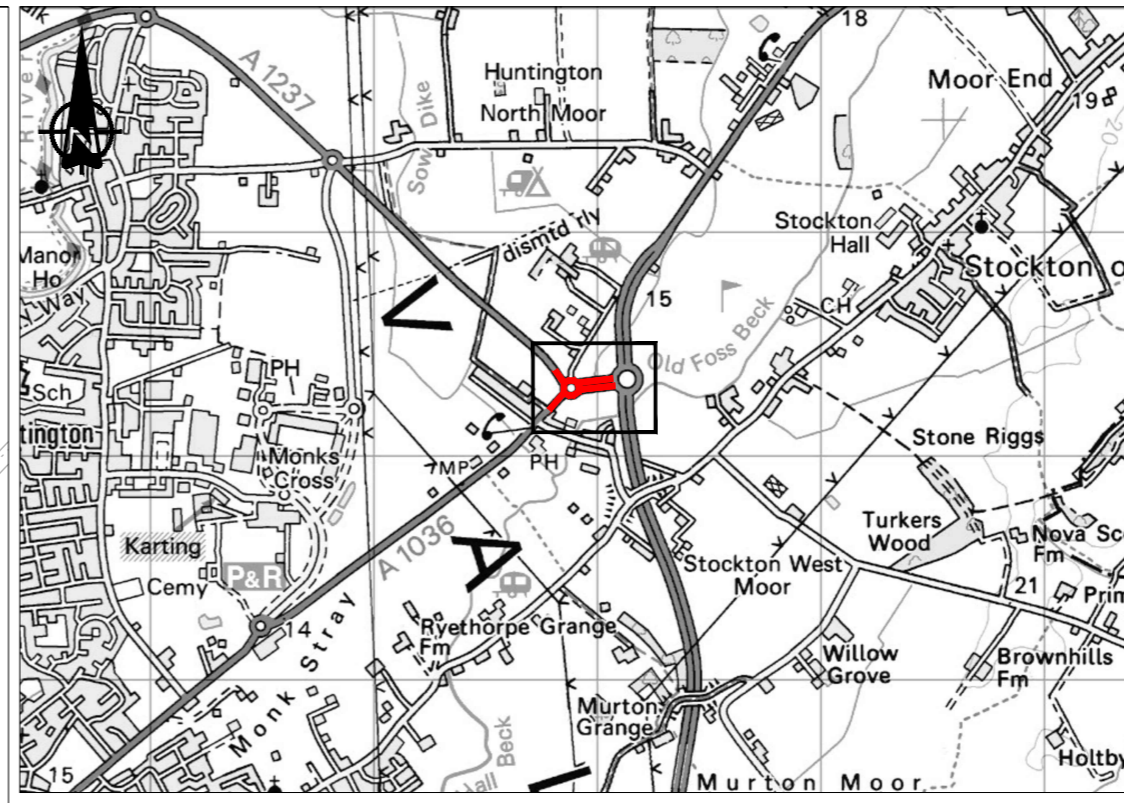
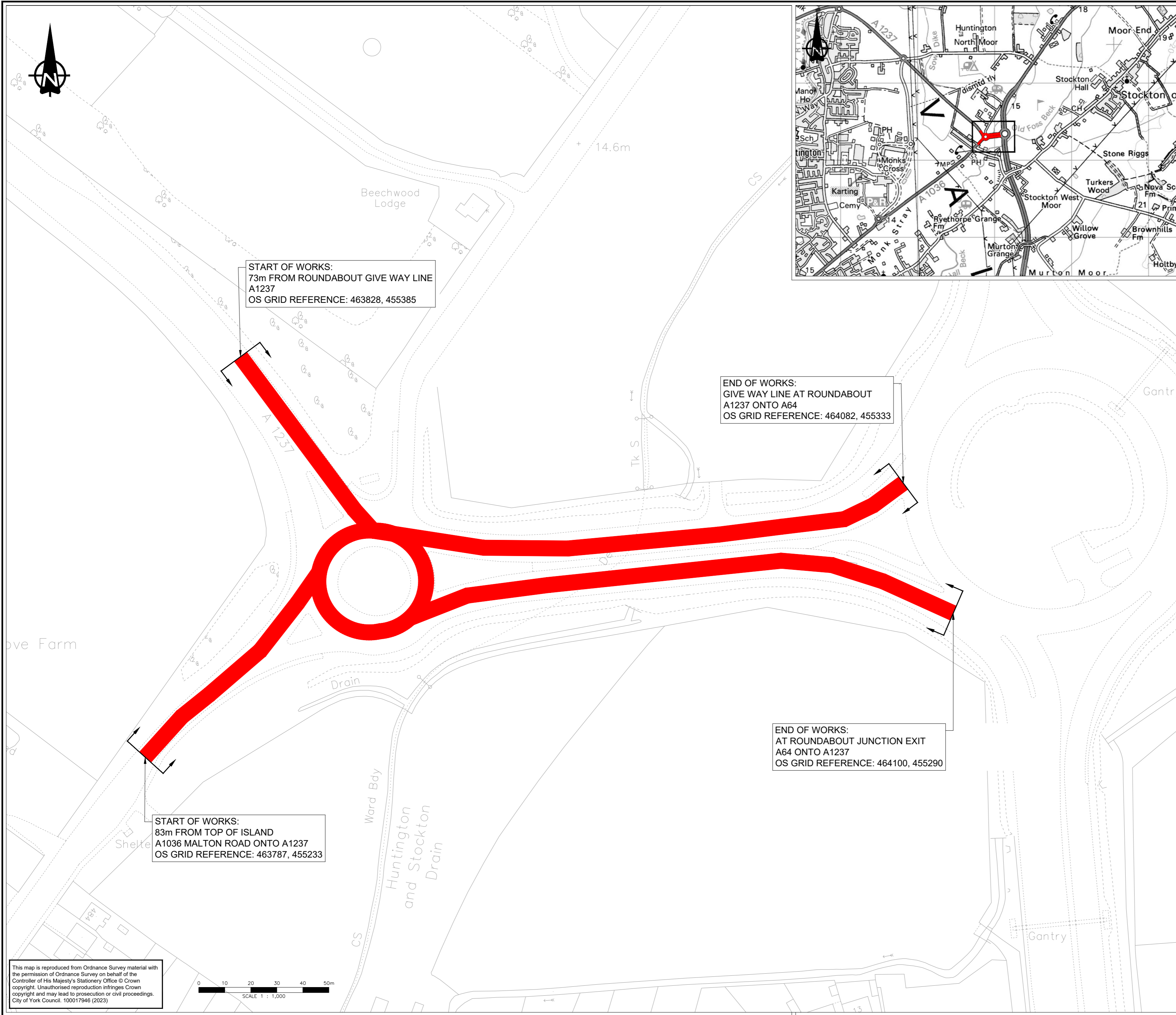

DO NOT SCALE

- NOTES:**
- THIS DRAWING IS BASED ON AN ORDNANCE SURVEY PLAN, THEREFORE THERE MAY BE INACCURACIES WITH THE LAYOUT.
 - ALL DIMENSIONS ARE IN METRES UNLESS OTHERWISE STATED

KEY:

█ EXTENT OF WORKS

REV	DATE	BY	DESCRIPTION	CHK	APP
P02	23/11/2023	OS	CHANGE OF SITE EXTENTS	JB	DM
P01	19-10-2023	AS	FIRST ISSUE	SD	SP

DRAWING STATUS: **D2 - FOR TENDER**



Dale House, Mount View, Standard Way Business Park, Northallerton
DL6 2YD, UK
wsp.com

CLIENT:



PROJECT:
**CITY OF YORK CAPITAL MAINTENANCE 24-25
MALTON ROAD**

TITLE:
LOCATION PLAN

SCALE @ A2: 1:1000	CHECKED: SD	APPROVED: SP
PROJECT No: 70112373	DESIGNED: AS	DRAWN: AS
DRAWING No: 70112373-008-WSP-100		DATE: 19/10/2023

REV: **P02**

© WSP UK Ltd

This map is reproduced from Ordnance Survey material with the permission of Ordnance Survey on behalf of the Controller of His Majesty's Stationery Office © Crown copyright. Unauthorised reproduction infringes Crown copyright and may lead to prosecution or civil proceedings. City of York Council. 100017946 (2023)

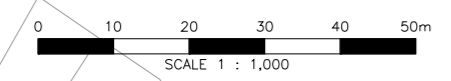

LTP CARRIAGEWAY PROGRAMME

ITEM

6

LOCATION

A1079 Grimston Approach

ROAD NO

WARD/PARISH

Osbalwick & Derwent

SCHEME DRAWING NO

DESCRIPTION
OF WORK

Resurfacing York rd junction (Dunnington) to Grimston Bar
roundabout. Section of Elvington lane included

*SPECIFICATION
RECOMMENDATION*

Heavy duty carriageway resurfacing

CW WIDTH

Av 8.5m

FW WIDTH

CW LENGTH

600

FW LENGTH

CW AREA

5100

FEE

TOTAL ESTIMATE

£334666

NOTES

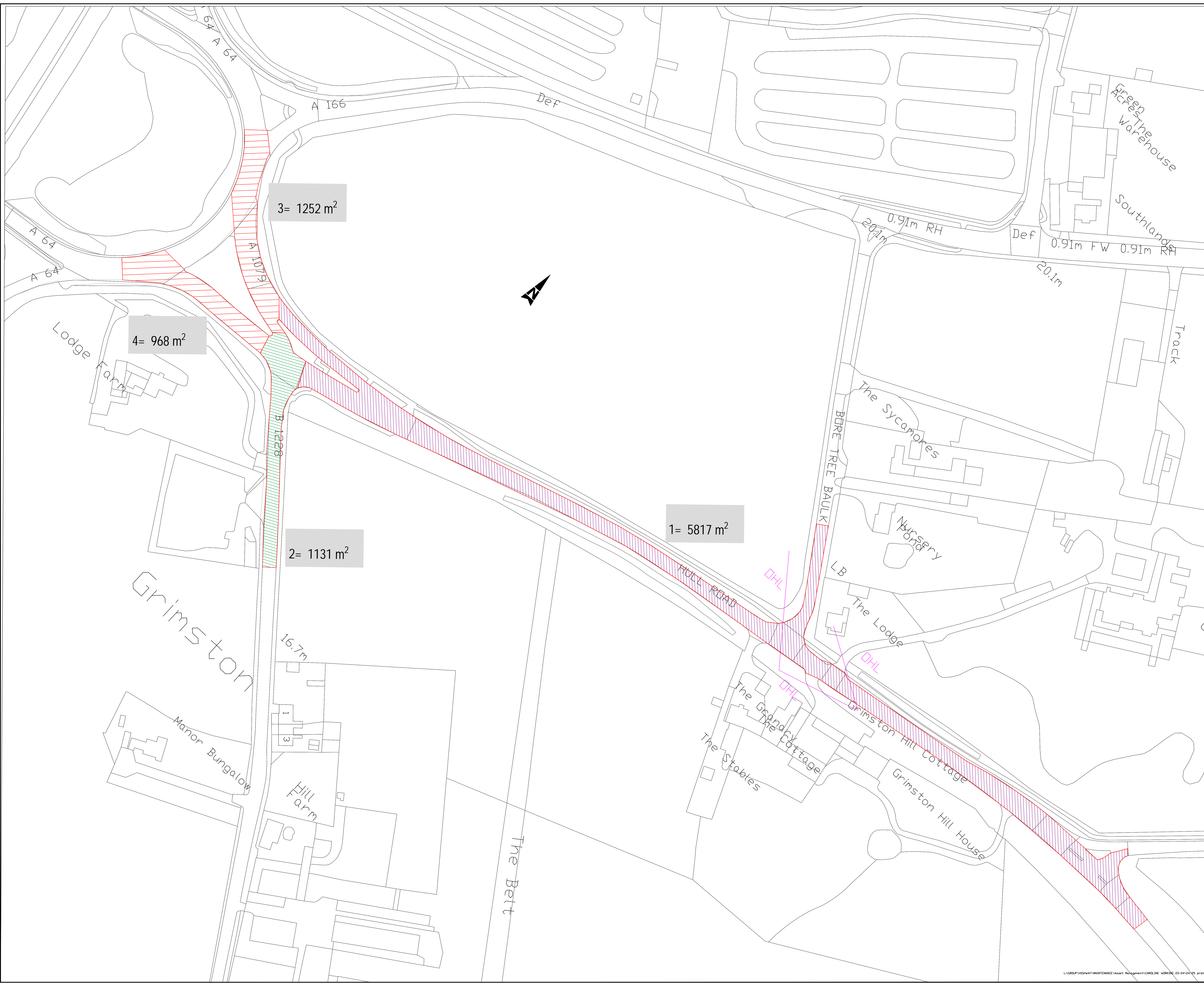

NOTES:

A1079 GRIMSTON BAR APPROACH

1. All dimensions in metres unless otherwise stated.
2. Do not scale from this drawing.

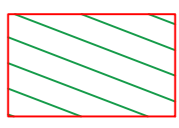
-  1- A1079RB- York rd =5817m²
-  2-Elvington Ln access =1131m²
-  3 & 4 -RB sections =968 +1252= 2200m²

Total area= 9148m²

 OHL Overhead lines

BASED UPON THE ORDNANCE SURVEY MAPPING WITH THE PERMISSION OF THE CONTROLLER OF HER MAJESTY'S STATIONERY OFFICE. © CROWN COPYRIGHT. UNAUTHORISED REPRODUCTION OFFENCES COMPLY WITH AND MAY LEAD TO PROSECUTION OR CIVIL PROCEEDINGS. City of York Council. IS Licence No. 1000 20818

DRAWING TYPE

Revision	By	Checked/Approved	Date	Description



Highways – Transport Projects and Delivery Team
Eco Depot, Hazel Court, James Street, York, YO10 3J5
www.york.gov.uk

Project
2024/25 Carriageway Schemes

Drawing
Proposed Programmes
HULL RD Grimston RB approach
Resurfacing

Drawn by CSS Date: 03/09/2023
Checked by Date:
Authorised by Date:

Drawing No. Revision
A

Drawing Scale: NTS A0

CAD Filename: Plot Scale: NTS

LTP CARRIAGEWAY PROGRAMME

ITEM

7

LOCATION

Elvington Lane (York Maze)

ROAD NO

WARD/PARISH

Osbalwick & Derwent

SCHEME DRAWING NO

DESCRIPTION
OF WORK

Carriageway Resurfacing

*SPECIFICATION
RECOMMENDATION*

Carriageway Resurfacing

CW WIDTH

6

FW WIDTH

CW LENGTH

1214

FW LENGTH

CW AREA

7345

FEE

TOTAL ESTIMATE

£ 356671

NOTES

--

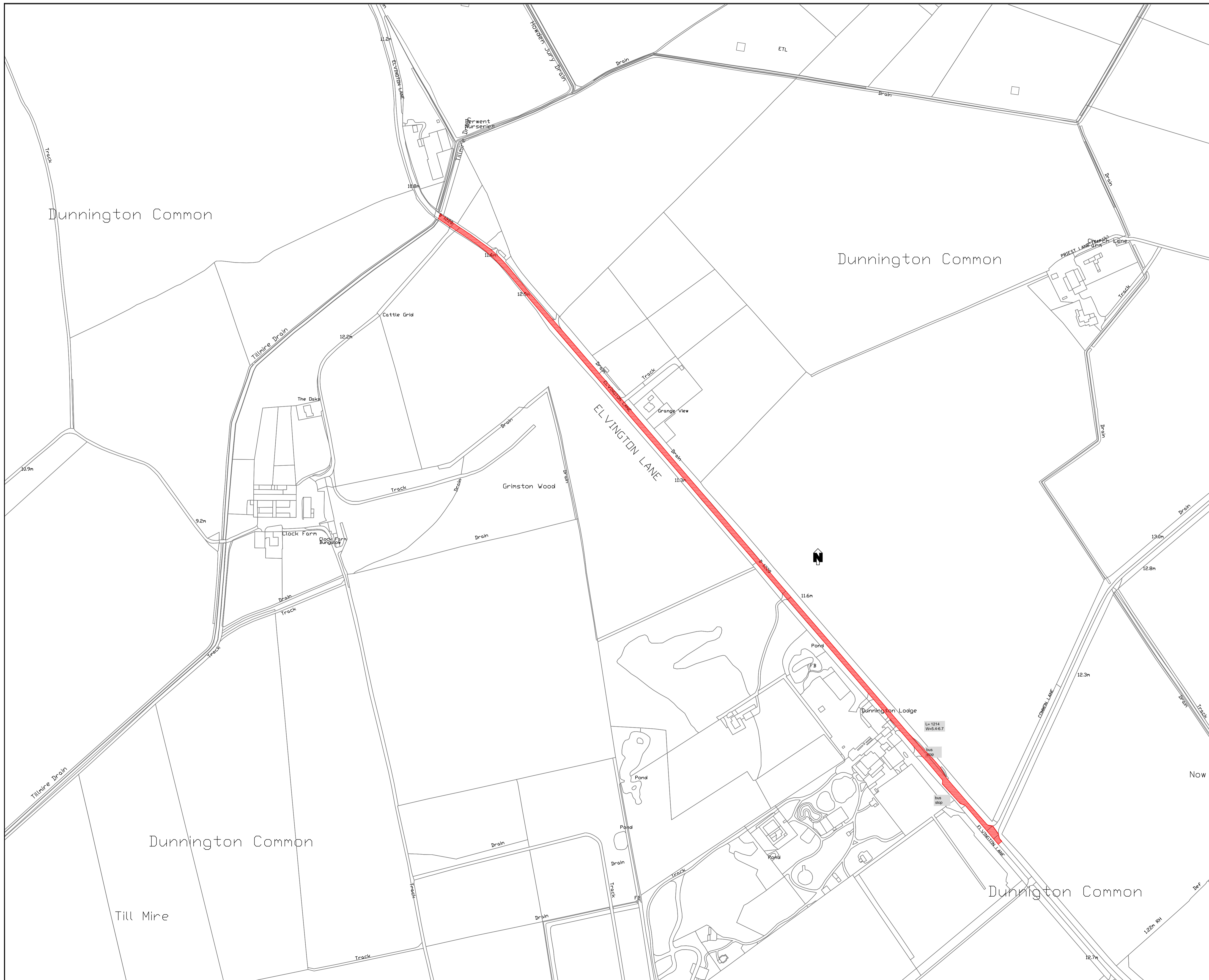

- NOTES:
1. All dimensions in metres unless otherwise stated.
 2. Do not scale from this drawing.

KEY:

■ Location of Works

Total surface area for ELVINGTON Lane full extents= 1214 x 6.03=7345 m²

HSE
 Overhanging trees
 Bus Route
 Businesses & farms within site

BASED UPON THE ORDNANCE SURVEY MAPPING WITH THE PERMISSION OF THE CONTROLLER OF HER MAJESTY'S STATIONERY OFFICE. © CROWN COPYRIGHT. UNAUTHORISED REPRODUCTION OR USE, INCLUDING BY ANY MEANS, IS PROHIBITED. City of York Council OS Licence No. 1000 20818

TENDER ISSUE

Revision	By	Checked	Approved	Date	Description
A	XX	XX	XX	0X/21	



Project 2024-25 Carriageway Resurfacing LOCATION PLAN

Drawing Elvington Lane The Maze
 Elvington
 Wheldrake

Drawn by CSS Date: NOV 23
 Checked by aaaa Date: XXXXXX
 Authorised by aaaa Date: XXXXXX

Drawing No. HMS23/..... Revision A

Drawing Scale: NTS A1

CAD Filename: Computer Filename Plot Scale: nts

LTP CARRIAGEWAY PROGRAMME

ITEM	<input type="text" value="8"/>		
LOCATION	<input type="text" value="Almsford Road"/>		
ROAD NO	<input type="text"/>		
WARD/PARISH	<input type="text" value="Acomb"/>		
SCHEME DRAWING NO	<input type="text"/>		
DESCRIPTION OF WORK	<input type="text" value="Concrete Rd repairs between Cranbrook Rd- Carr Ln"/>		
<i>SPECIFICATION RECOMMENDATION</i>	<input type="text" value="carriageway resurfacing"/>		
CW WIDTH	<input type="text" value="6.4"/>	FW WIDTH	<input type="text"/>
CW LENGTH	<input type="text" value="72"/>	FW LENGTH	<input type="text"/>
CW AREA	<input type="text" value="Approx. 515"/>		<input type="text"/>
FEE	<input type="text"/>		
TOTAL ESTIMATE	<input type="text" value="£ 86329"/>		

NOTES

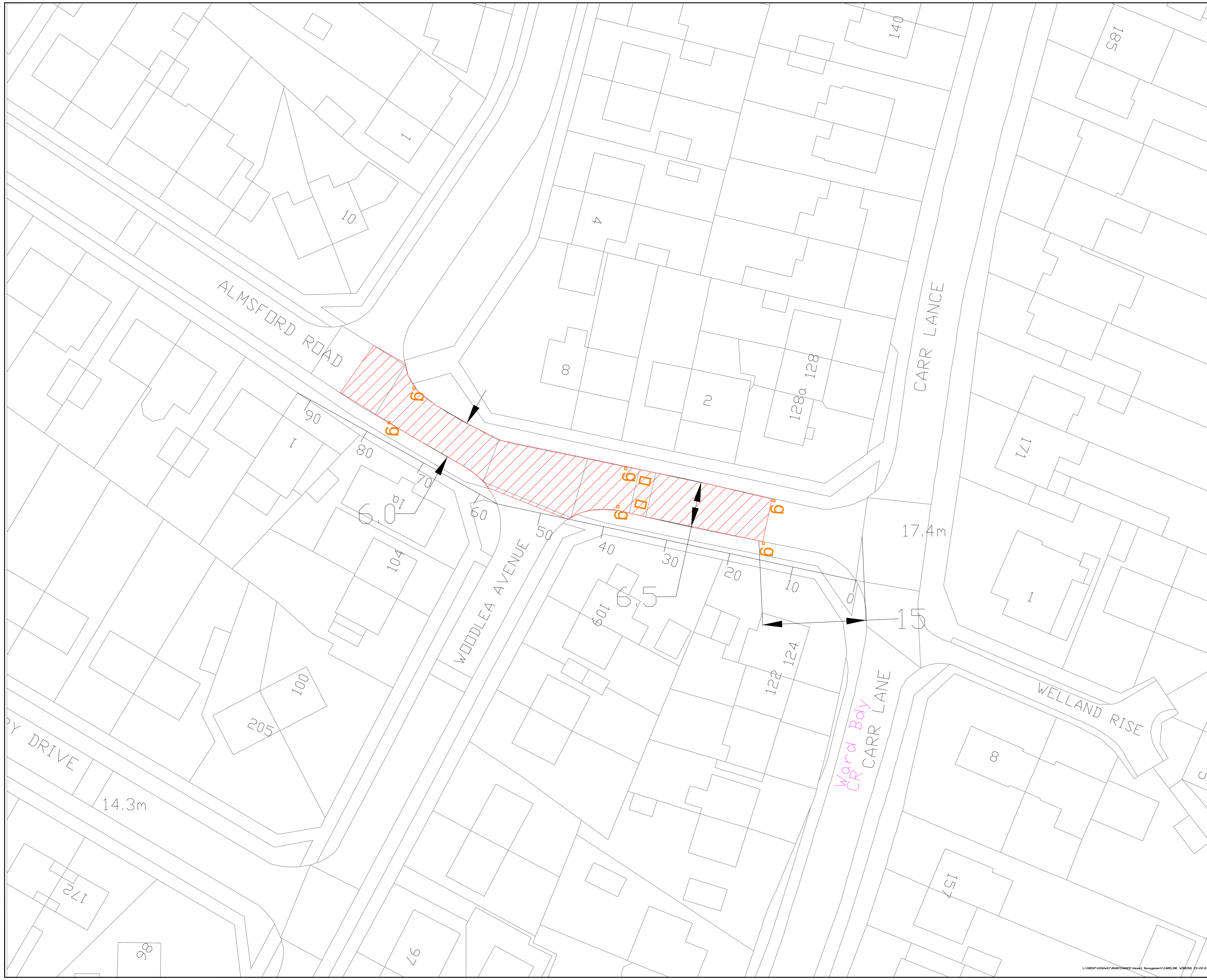

NOTES:
2024-25 large patching

HSE
 residential street
 may be concrete
 beneath overlay
 Busy cut through
 commuter road

large patch / Plane &
 Resurf, install Bolt on
 Speed cushions to
 replace bitmac ones

72x 6.4m = 515m²

BASED UPON THE ORDNANCE SURVEY MAPPING WITH THE PERMISSION OF THE CONTROLLER OF HER MAJESTY'S STATIONERY OFFICE. © CROWN COPYRIGHT. UNAUTHORISED REPRODUCTION INFRINGES CROWN COPYRIGHT AND MAY LEAD TO PROSECUTION OR CIVIL PROCEEDINGS. City of York Council OS Licence No. 1000 20818

DRAWING TYPE

Revision	By	Checked	Approved	Date	Description



Highways – Transport Projects and Delivery Team
 Eco Depot, Hazel Court, James Street, York, YO10 3DS
 www.york.gov.uk

Project
 2024/25 Carriageway Schemes
 LARGE PATCHING
 WORKS

Drawing
 ALMSFORD RD WESTFIELD

Drawn by CSS Date: 03/05/2023
 Checked by Date:
 Authorised by Date:

Drawing No. Revision
 2 of 4 A

Drawing Scale: NTS A0
 CAD Filename: Plot Scale: NTS